

# EasySnap Hanging Banner

## Product Parts

- 1 - Snap Rail (x2)
- 2 - Hanging Clip (x2)
- 3 - End Cap (x4)
- 4 - Graphic

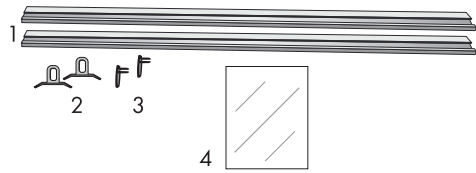

24" x 30"



30" x 40"



36" x 48"

## Display Set-Up

### Step 1

On a clean flat surface, lay graphic flat.  
Open the Snap Rail (1).

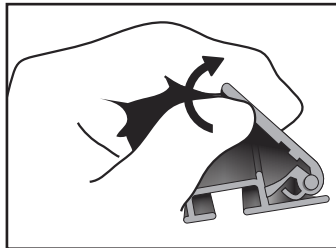

Open Snap Rail

### Step 2

With Graphic (4) face side up, fully insert top edge into the groove of the Snap Rail (1) and snap it shut. Repeat for bottom Snap Rail (1).

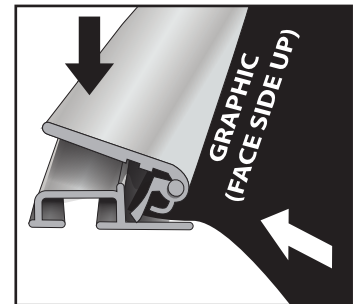

Insert Graphic then snap shut

### Step 3

Insert Hanging Clips (2) into groove on top rail and slide into desired position.

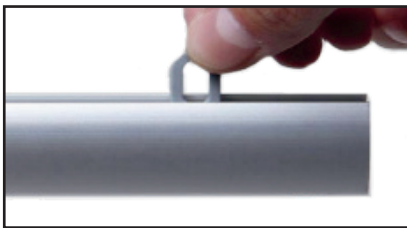

### Step 4

Align and press each End Cap (3) into the end of each Snap Rail (1).

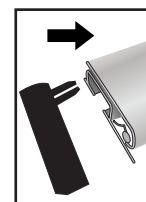

Insert End Cap

## Storage and Care

To clean graphic or hardware, gently wipe with a damp cloth.